

FLOW MEASUREMENT & CONTROL

Flow & Pressure Meters Code 477G

Conflow is renowned the world over as the leading supplier of specialist components and systems for dust suppression, fire suppression and all aspects of water control in underground coal Mining.

Today Conflow products can be found operating both on the surface and underground in all the major mining industries, from coal to gold, in more than 30 countries around the world. Furthermore, wherever minerals are moved in bulk – such as quarries, power stations and steel works - Conflow products are helping to reduce the negative impact on the local environment.

At Conflow our aim is to provide you with a comprehensive range of services to meet your individual needs.



Description

The **Conflow Code 477** – Flow and Pressure Meter indicates the volume rate of flow and the system pressure in a fluid pipeline.

The product is the Code 452 Flowmeter together with a pressure gauge block built in line on the outlet.

This concept overcomes the normal problem of fitting a standard pressure gauge in a vulnerable position on the side of a flowmeter. The pressure gauge block encompasses the features of the Code 91 Mine Gauge with the addition of an isolating valve built in to the block.

This isolates the pressure gauge from the system so that the gauge tube is only subject to the system pressure when a reading needs to be taken. The isolating valve is also used to restrict the hydraulic pulsation in certain circumstances so that a steady pointer indication ensues.

Typical Applications

- On board monitoring of ITP systems on coal cutting machines as a diagnostic check to ensure pressure and flow of water circuit is above the required trip levels

FLOW MEASUREMENT & CONTROL

Flow & Pressure Meters Code 477G

Features

- Sizes from 3/4" up to 1 1/2"
- Maximum working pressure 315 bar (1" unit)
- Individually calibrated to $\pm 2\%$ of indicated reading
- Provides the ability to monitor Flow and Pressure within the water circuit
- Based on the reliable 452 Flowmeter
- Glycerine filled for steady reading

Specifications

Unit Size	DIMENSIONS (mm)					Maximum Working Pressure (bar)	WEIGHT
	A	B	C	D	E		
3/4"	234	78	105	158	11 \emptyset	315	8.15 Kg
1"	243	78	105	158	11 \emptyset	315	7.95 Kg
1 1/4"	250	115	122	-	11 \emptyset	275	13.3 Kg
1 1/2"	205	115	122	-	11 \emptyset	275	14.1 Kg

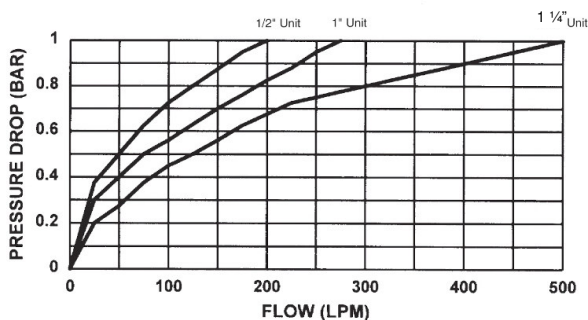
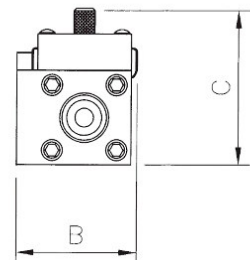
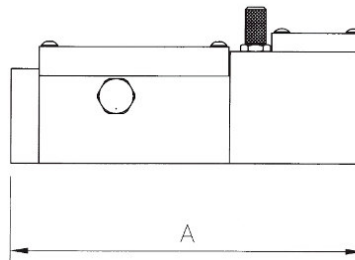
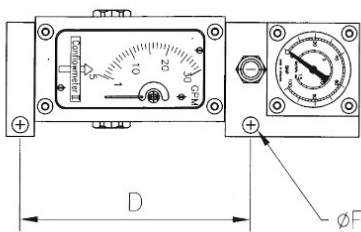

The information on this data sheet is accurate to the best of Conflow's knowledge, however we reserve the right to alter the product specification at any time. For any specific updated detail, please contact us.