

## PRESSURE MEASUREMENT & CONTROL

### Pressure Check Valve Code 103

Conflow is renowned the world over as the leading supplier of specialist components and systems for dust suppression, fire suppression and all aspects of water control in underground coal Mining.

Today Conflow products can be found operating both on the surface and underground in all the major mining industries, from coal to gold, in more than 30 countries around the world. Furthermore, wherever minerals are moved in bulk – such as quarries, power stations and steel works - Conflow products are helping to reduce the negative impact on the local environment.

At Conflow our aim is to provide you with a comprehensive range of services to meet your individual needs.



Code 103NSA

Code 103NS



Code 103M

### Description

The **Conflow Code 103M - Pressure Check Valve** provides a tapping point to enable the checking of pressure at a particular point in a system, without the need for a pressure gauge to be permanently located at each point. The pressure gauge is only connected at the time a pressure reading is required.

The **Conflow Code 103NS and NSA Pressure Check Valve** swivel adaptors are used in conjunction with a pressure gauge to enable readings to be taken at the tapping point.

The action of screwing the adaptor in to the Code 103M pressure check valve, causes a probe to push the valve ball off its seat and allows system fluid to enter the pressure gauge to register a pressure reading, ensuring operator safety.

Unscrewing the adaptor allows the ball to reseat thus isolating the system from the gauge again.

### Typical Applications

- Checking hydraulic pressure on each leg and ram on powered roof supports on coal faces
- Invaluable on applications where permanent gauges would get damaged.

## PRESSURE MEASUREMENT & CONTROL

### Pressure Check Valve Code 103

#### Features

- 3/8" BSP fitting
- Maximum working pressure 690 bar
- Enables periodical checks of on-line pressure without the need for any fixed gauges
- No interruption of the normal circuit

#### Specifications

| CODE 103M |                 |
|-----------|-----------------|
| Unit Size | 3/8" BSP        |
| A         | 50              |
| B         | 3/8" BSP or NPT |
| C         | 32              |
| Weight    | 0.17 Kg         |

| CODE 103NSA |                 |
|-------------|-----------------|
| Unit Size   | 3/8" BSP        |
| A           | 98              |
| B           | 37              |
| C           | 3/8" BSP or NPT |
| Weight      | 0.40 Kg         |

| CODE 103NS |                 |
|------------|-----------------|
| Unit Size  | 3/8" BSP        |
| A          | 74              |
| B          | 37              |
| C          | 3/8" BSP or NPT |
| Weight     | 0.30 Kg         |

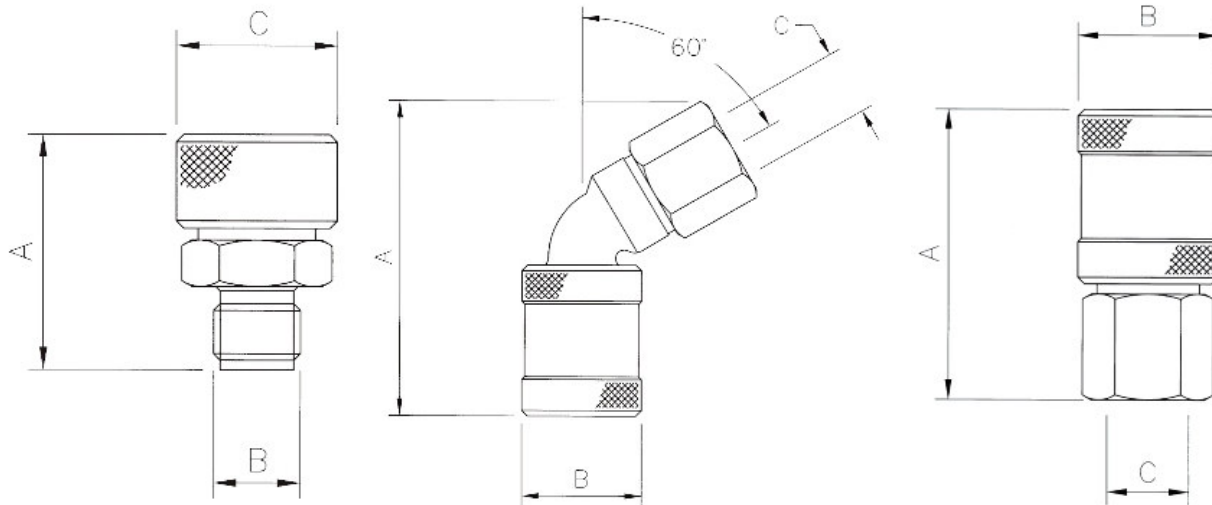

*The information on this data sheet is accurate to the best of Conflow's knowledge, however we reserve the right to alter the product specification at any time. For any specific updated detail, please contact us.*